

JOIN BYOD NETWORK

Turn on WiFi

1. Click on NTCs-BYOD

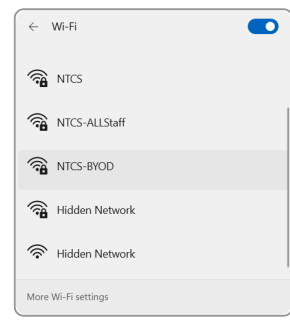

2. Enter the WiFi password.

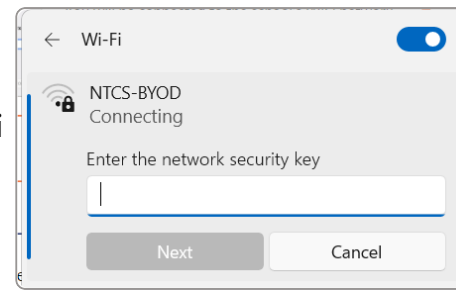

You will be connected to the school's WiFi network but not the Internet. To connect to the Internet you need to download and install certificates.

You may need to switch off your proxy settings before you join the WiFi. See [Configure Proxy Settings Instructions](#) below.

DOWNLOAD & INSTALL CERTIFICATES

1. Open your web browser and in the URL enter: <https://cert.education.nt.gov.au>

2. Navigate to **Certificates** and download

- Netskope Root Certificate
- Netskope Intermediate Certificate.

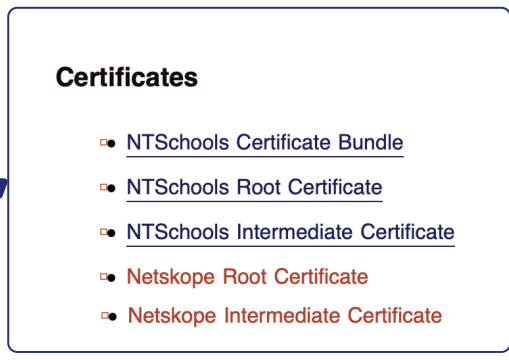

01

Open Windows Explorer to where the certificates were downloaded. Right-Click **NetskopeRootCA** and choose **Install Certificate**.

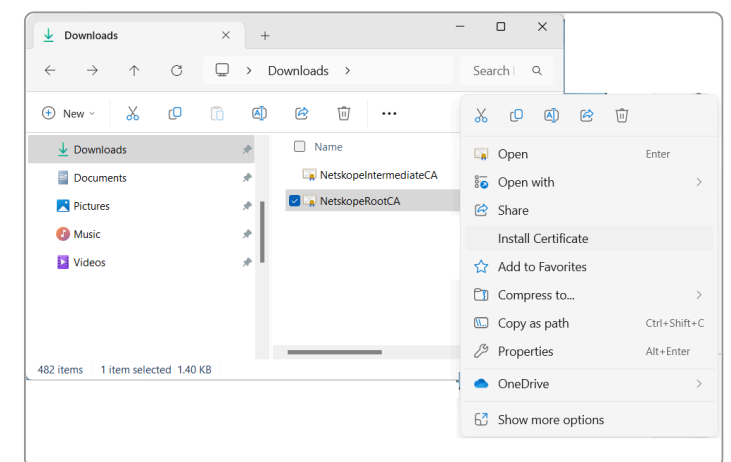

02

A security warning may appear about opening the files. Click **Open**.

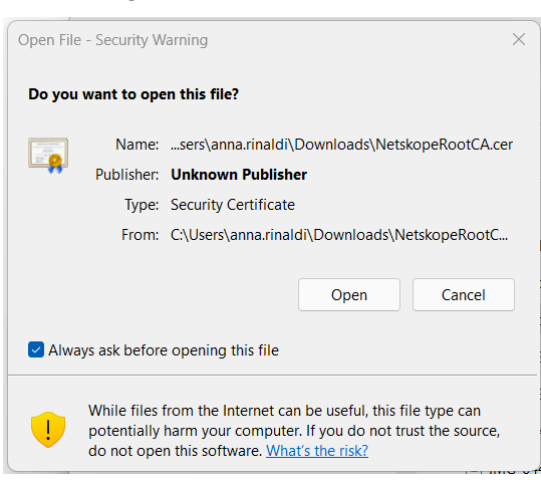

03

Select **Local Machine**. Click **Next**.

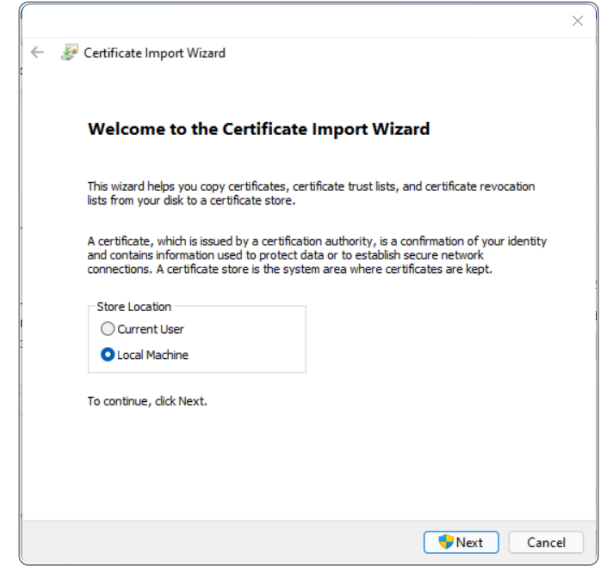

04

Select **Place all certificates in the following store**. Click **Browse**.

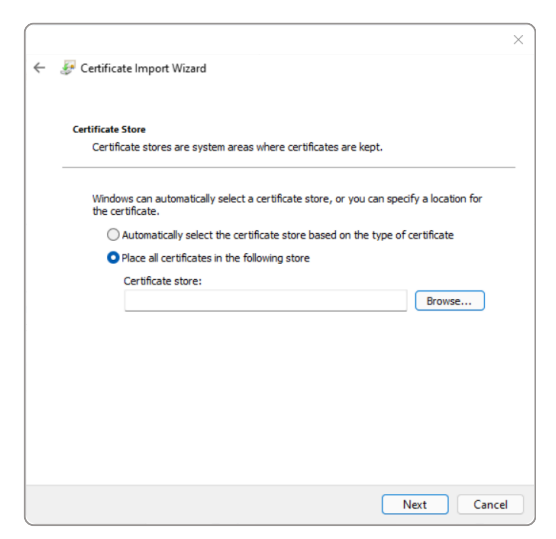

05

Select **Trusted Root Certification Authorities**. Click **Ok**.

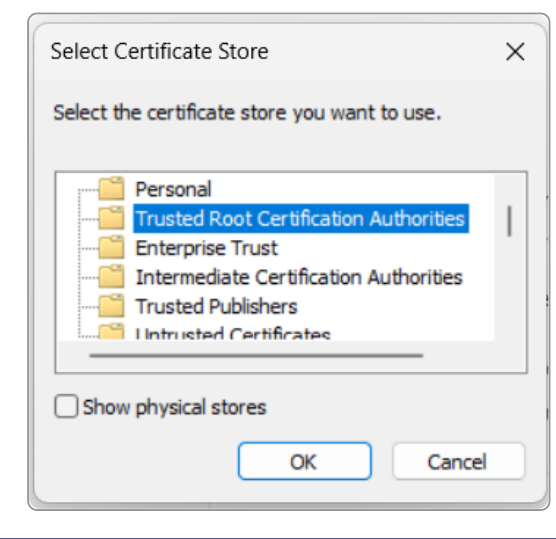

06

Click **Next**.

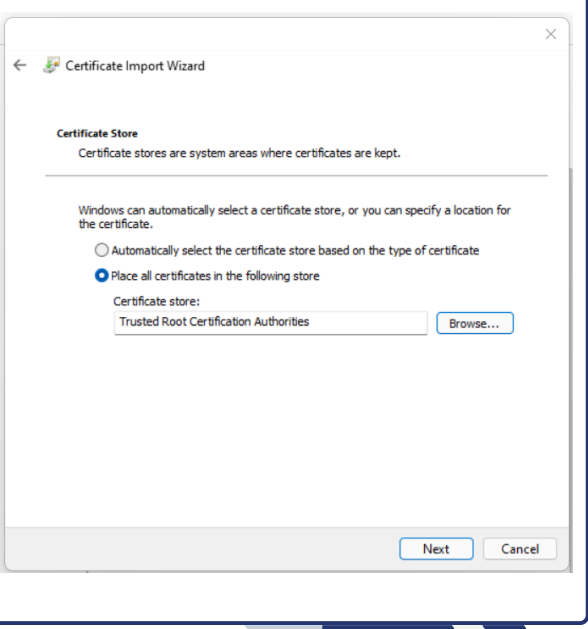

07

Click **Finish**.

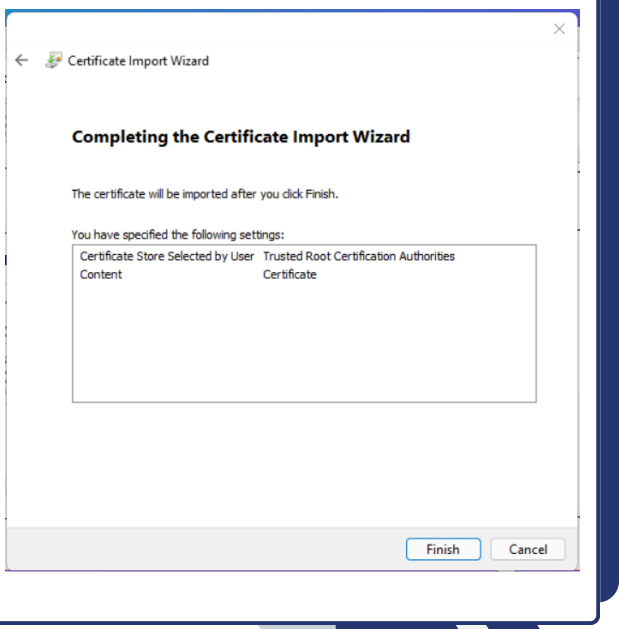

08

Install the Netskope Intermediate Certificate following steps 2 to 8 for **NetSkopeIntermediateCA**. See the below for details for Steps 02 and 06:

Step 02 - Select NetSkopeIntermediateCA

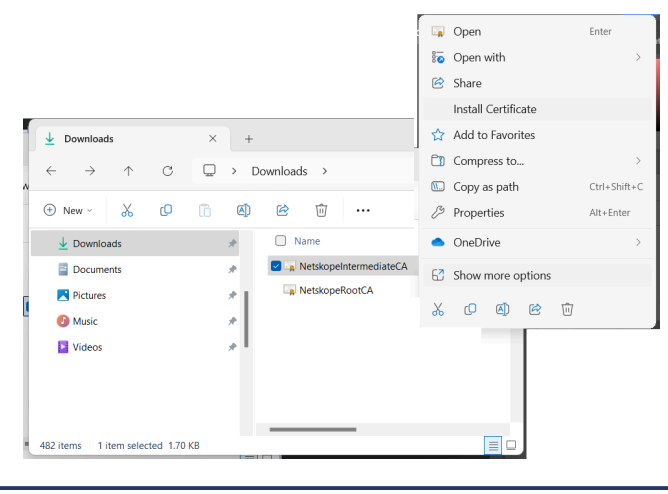

Step 06 - Select Intermediate Certification Authorities

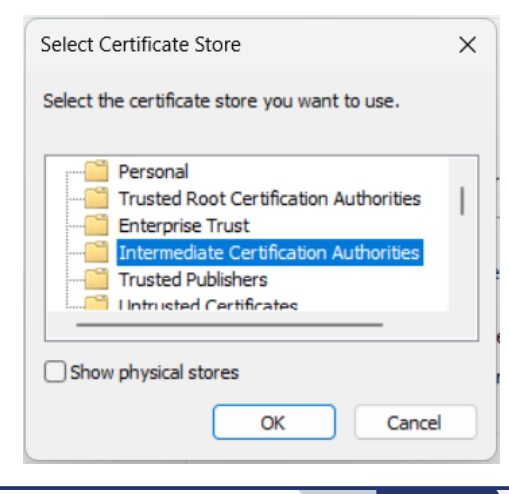

09

CONFIGURE PROXY SETTINGS

1 Open Proxy Settings

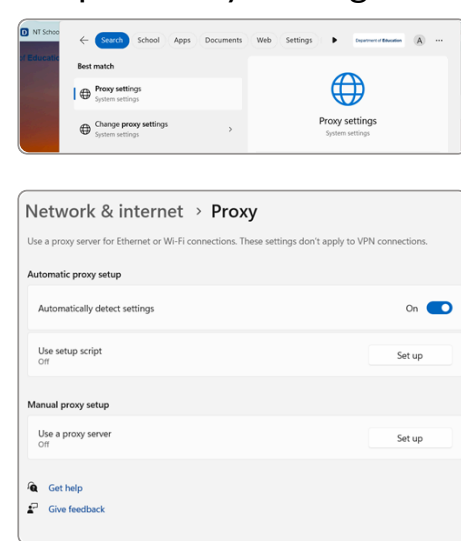

2 Turn off Automatic proxy setup

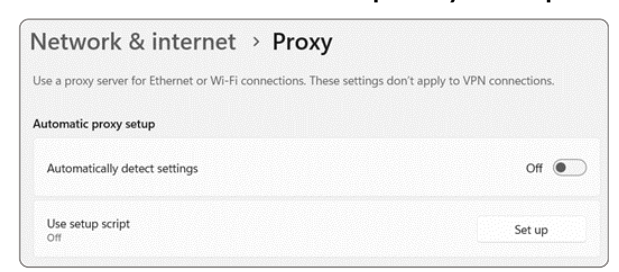

3 Set up the Manual proxy setup. Click **Set up**

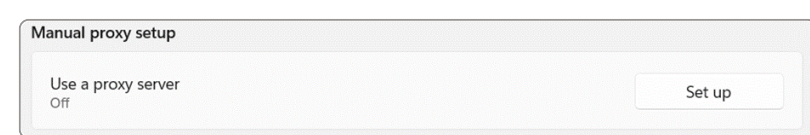

4 Turn Use a proxy server On

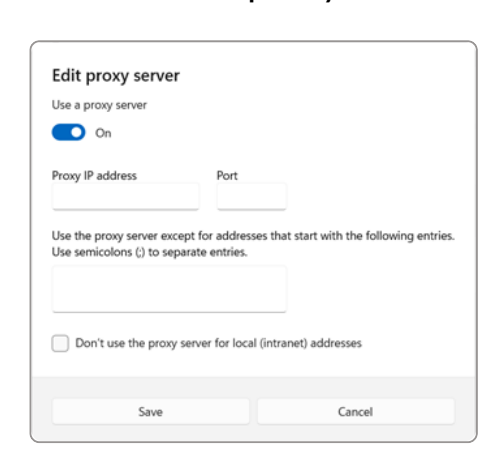

5 Enter the following details
 Proxy IP address: <http://proxygre.ntschoools.net>
 Port: **8080**
 Click **Save**. You may need to **restart** your laptop.

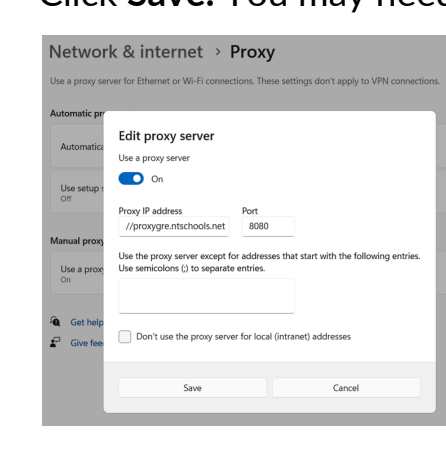

You might need to turn this off when you are trying to connect to your home WiFi. Remember to turn on when you return to school.